

MURRAY RIVER
PADDLESTEAMERS
ECHUCA

Fall in love with
PS EMMYLOU

Authentic Australian River Cruises



RETURN TRAIN
FARES FROM
MELBOURNE
Included

2024/2025 PREVIEW

Contents

Book With Confidence	3
PS Emmylou History	4
Your Authentic Australian Cruise	5
Special Offers	6
Cruising - That's All About You	8
Sightseeing - The All Inclusive Local Experience	10
A Taste of Australia	12
Welcome Aboard	14
3 Night Discovery	16
4 Night Explorer	18
7 Night All the Rivers Run	20
Extend Your Stay	22
Driving Tour Routes to Echuca	24

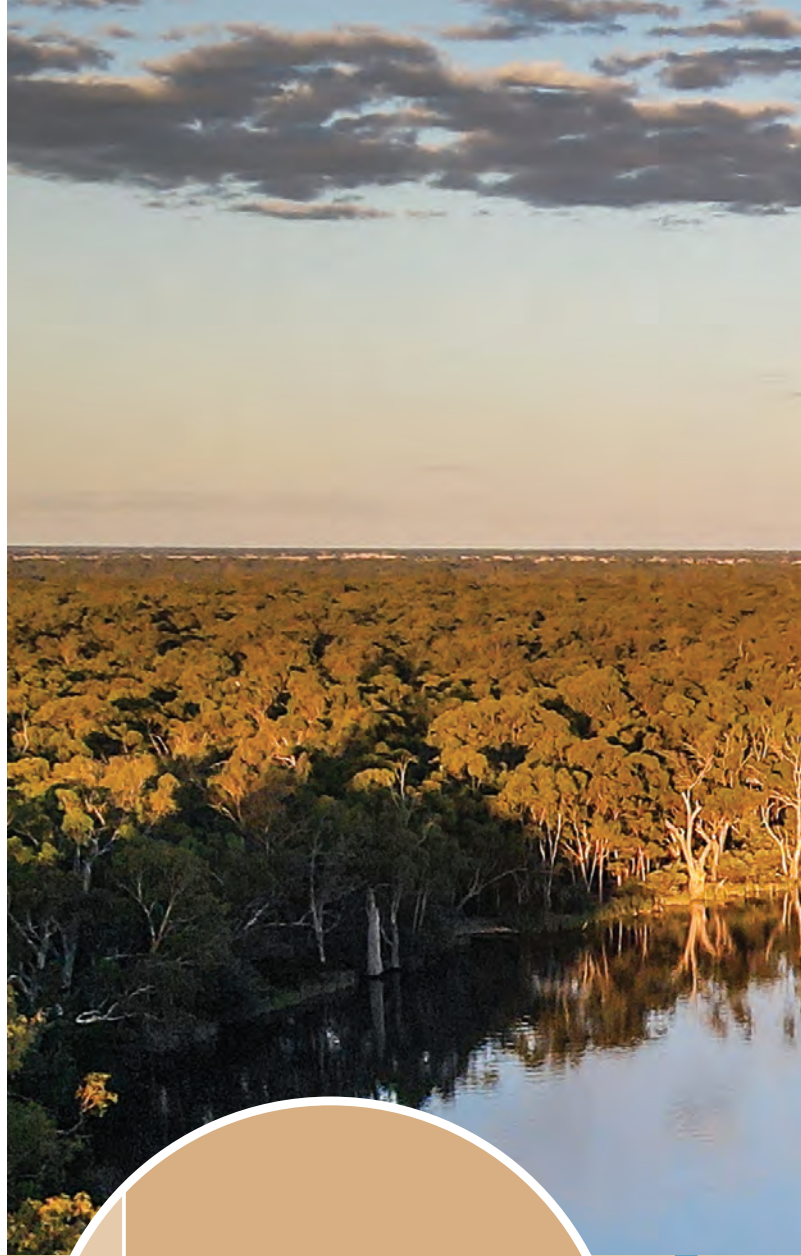



Book with CONFIDENCE



Flexible Bookings & Low Deposits

We know even the best planning may have to change so we offer a low deposit of just \$400 per person to secure your booking which is refundable within 7 days. This gives you the peace of mind to change the date or cancel your booking during this period for a full refund.



Travel Insurance

In line with changes made by the Australian Government it is no longer a requirement to be fully vaccinated against COVID-19 to cruise aboard PS Emmylou. We do however highly recommend that all guests are fully vaccinated with up-to-date boosters. We also highly recommend that you take adequate Travel Insurance at least 30 days prior to your departure.



COVID-19 Cruise Well Program

From bow to stern, we're taking extra measures to ensure your health and safety when onboard the Emmylou. Through our Cruise Well Program we follow strict hygiene standards and procedures. We are an accredited, Covid-ready business with NSW Health and ATEC, and in addition, we're recognised by the World Travel & Tourism Council, and the Safe Travel global branding, for our high health and hygiene protocols.

Your crew are trained on appropriate hand hygiene and sanitising practices, and we monitor and maintain these practices to the highest standards on every cruise. While there may be a few additional requirements to protect our guests and staff, your experience on the Emmylou has not changed.



PS Emmylou

HISTORY

PS Emmylou, one of Australia's most iconic Paddlesteamers, cruises the Murray River from Echuca, just a 2.5-hour drive from Melbourne. Named after the renowned American country singer Emmylou Harris, this vessel has been a host to thousands of people, including her namesake, delighting them with unforgettable experiences. PS Emmylou also starred in the popular TV series *All the Rivers Run*, where she was renamed the PS Providence.

What makes Emmylou special is her beautifully restored 1906 Marshall and Sons steam engine, which makes her the only wood fired Paddlesteamer in the world offering regular scheduled accommodated river cruises. The side-wheel Paddlesteamers are distinctly Australian, having first plied the Murray River in 1853, establishing a thriving industry that lasted until the rail and roads began servicing the region at the turn of the century. By 1873, there were 240 boats trading along the Murray River, bringing prosperity and development to the region and keeping the previously out-of-the-way settlements in touch with the cities. With the introduction of the railway, the paddlesteamers and their crews gradually lost work until the riverboat industry became but a shadow of its illustrious past.

However, PS Emmylou reminds us of the romantic days of the paddlesteamers and is now an Australian icon of the river. Built locally during 1980-82 in the style of 19th-century paddlesteamers, she is perfectly at home at the Port of Echuca, residing with the last few remaining paddlesteamers of the past. This 30-meter-long and 10-meter-wide steel-hulled vessel with a timber deck underwent a luxury upgrade and fit-out in 2018. The new contemporary cabins and ensuites feature fine linens topped with silky duvets, with the boat's premier cabin, the Emmylou Suite, located on the front Upper Deck, with French Doors opening to a deck and 180-degree views of the river. The vessel accommodates just 16 guests in 8 deluxe cabins, offering small boat boutique cruising at its finest.

Locally owned and operated for over 25 years, the business continues to grow and expand on strong foundations. We are proud to continue the tradition of overnight cruising on Australia's greatest waterway, providing our trademark level of country hospitality aboard an authentic paddlesteamer. Join us for a unique opportunity to connect with Australia's inland history, geography, culture, and cuisine.



Your Authentic AUSTRALIAN RIVER CRUISE

Cruise along the majestic Murray River at an ambling speed aboard the world's only accommodated wood-fire paddle steamer.



The Murray River, also known as 'the Mighty Murray,' is a magnificent natural wonder that stretches over 2,000 kilometres from Kosciusko National Park in New South Wales, through Victoria, and all the way to Goolwa, South Australia. Its impressive size and beauty have earned it its fitting nickname, as it is the world's third-longest navigable river, surpassed only by the Nile and the Amazon.

For over 40,000 years, Aboriginal communities have lived alongside the river and have left their mark on the landscape. Evidence of their habitation, dating back thousands of years, can still be seen today. The river continues to play an essential role in the agricultural industry for much of inland Victoria and serves as a significant water supply for over 1.5 million households.

The Murray River offers a unique destination to explore one of Australia's most beautiful regions. Visitors can enjoy exploring the riverside towns, discovering the local wildlife, and, of course, taking a relaxing cruise on an old paddlesteamer. One such paddle steamer, the Emmylou, has become a popular and iconic choice for thousands of visitors looking to experience the river in a unique and luxurious way.

Emmylou is the world's only accommodated wood-fire paddle steamer and has been masterfully restored to blend the old with the new. This authentic luxury cruise seamlessly immerses passengers in a bygone era while still providing modern-day

comforts. The ship offers three, four, or a combined 7-night cruise, all-inclusive experiences that allow guests to enjoy the journey as much as the destination.

As passengers board the Emmylou, they are welcomed by the warmth of the 1906 steam engine, and they can watch as the engineer stokes the boiler. Guests can even climb into the wheelhouse to chat with the skipper or sit back and enjoy the changing reflections in the water. The journey offers something for everyone, whether you're captivated by the river itself, the region's pioneering history, or just looking for a way to unwind and relax, the Emmylou provides the ultimate antidote to stress - a soothing, soul-calming river journey with non-stop pampering from friendly crew members, mouth-watering cuisine, and mesmerising scenery. You will experience the peace, tranquillity and relaxation this unique and very Australian experience offers, and just like many before, ***you will fall in love with Emmylou*** as she unhurriedly saunters down the river.

Despite its small size, the Emmylou has many nooks and crannies where guests can pull up a chair and take in the breathtaking views. The only crowds you'll experience are the flocks of Australian White Ibis feeding in the marshes, Kingfishers hunting for a meal, and mobs of kangaroos. The Emmylou offers an unforgettable and truly unique way to explore the magnificent Murray River and the surrounding region.

Special OFFERS

BOOK
with
Friends

Save \$300 per couple

Gather some friends and save \$150 per person or \$300 per couple. Available when six or more guests' book twin share at the same time and travel on the same cruise. Combinable with 10% off peak offer.

Cruise Off
Peak and
Save 10%

Save Up to \$804 per couple

With over 90% of winter days bright and sunny experience the beauty of the Murray during June, July or August and save up to \$804 per couple when combined with our "Book with Friends" offer.

Solo
Travellers

Save 15% When Cruising Off Peak

Solo travellers who are open to cruising during off-peak times can enjoy an extra 15% discount on the typical Solo Supplement. This means you will only have to pay a 45% surcharge instead of the usual 60% during peak departures. Additionally, solo travellers can join our Solo Standby List to be notified of last-minute availability without any surcharge.



“Emmylou is a little bubble of ease, harmony and calm. *It's all so addictively relaxing.*”



Cruising

THAT'S ALL ABOUT YOU

At Murray River Paddlesteamers, we strive to ensure that our guests have a hassle-free and memorable experience on our cruises. That's why we have made sure to include almost everything you need for a comfortable and enjoyable journey. With us, you won't have to worry about optional onboard tours or any additional charges that might dampen your experience.

Moreover, we understand that some guests prefer a kid-free environment to relax and unwind, which is why our cruises are specifically designed for adults. You can be certain that you will be cruising with like-minded guests who share your interests and passions.

We take pride in offering exceptional service and attention to detail, from the comfortable accommodations to the delectable cuisine and mesmerizing scenery. Our team of friendly and knowledgeable crew members are always at your service to ensure that you have a relaxing and stress-free experience on board.

So, sit back, relax and let us take care of everything for you on your Murray River cruise. We promise to make it an unforgettable journey that you will cherish for years to come.

Your COMPREHENSIVE INCLUSIONS:



Return V/Line Train from Melbourne to Echuca

Return Echuca Station Transfers

Return PS Emmylou Coach Transfers

All Meals Including Onshore Tours

Morning and Afternoon Tea

Selected Wines & Beer with dinner service

Complimentary Barista Coffee, Fine Teas, Soft Drink and Water

Premium Onshore Guide Tours

Award winning service

Riverside Dining & Campfires with entertainment

Complimentary Wi-Fi

All onboard Gratuities

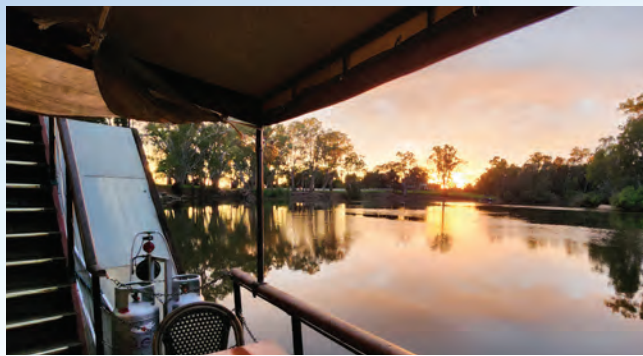



“A great way to relax and unwind whilst being pampered by the professional and courteous staff.”



Must See Sights

Our team of experienced professionals ensures that you won't miss out on anything during your Murray River cruise. Our team will make sure that you see and experience everything the river has to offer. From getting up close to nature and observing the wildlife to meeting local property owners and hearing their fascinating stories, our all-inclusive package covers it all. With our knowledgeable guides, you can learn about the river's history, wildlife, and culture, making your cruise an educational and enriching experience.



Free Time Your Way

PS Emmylou offers a tranquil environment perfect for those who prefer to unwind with a good book. Emmylou has plenty of cozy nooks where you can sit back and relax as you cruise the river. While onshore tours are available, they are entirely optional, so you have the freedom to choose how you spend your time on board. If you'd rather take a peaceful stroll along the riverbank or simply stay aboard and soak up the scenic views, the choice is yours.



Friendly Onboard Crew

We take pride in providing personalised and attentive service to our guests aboard PS Emmylou. With a maximum of 16 guests and four crew, our experienced team is always available to cater to your needs and ensure you have a comfortable and enjoyable cruise. Our onboard Chef is skilled at creating delicious meals and can accommodate most dietary requirements. Just let us know your needs prior to your cruise, and we'll take care of the rest. So, sit back, relax, and let us take care of everything while you soak up the beautiful scenery of the Murray River.

Sightseeing

ALL INCLUSIVE LOCAL EXPERIENCE

Explore the hidden gems of the Murray River with our unique sightseeing activities. Our onshore tours will take you to off-the-beaten-track places of historical, geographical, and cultural significance such as Perricoota Station and local riverside wineries where you can engage in conversation with the local owners.

Experience an eco-discovery cruise aboard the Murray Explorer and dine under the Southern constellations with our signature riverside BBQ complete with entertainment and a campfire. Our fully immersive 7-night cruise includes a Silo Arts Tour with a pub lunch at Colbinabbin and a guided historic walk of the Port of Echuca.

Whether you're a history buff, in need of relaxation, or simply want to experience the beauty of the river, our cruises offer it all, leaving you feeling refreshed, recharged, and knowledgeable about the stunning Murray River region.

“The peace,
tranquility and
relaxation this unique
and very Australian
experience offers
is just magical”



A Taste OF AUSTRALIA



Our onboard chef draws inspiration from the heartland of Australia, using the region's diverse produce to create hearty meals with a contemporary twist.

You can start your day with a selection of continental options, such as pastries, cereals, and fresh fruits, or opt for a traditional full English breakfast. Our chef takes care of morning tea, lunch, and afternoon tea, allowing you to focus on the day's activities without worrying about an empty stomach. Depending on the itinerary and onshore tours, these meals may range from hot lunches to gourmet picnics on the riverbank. In the evenings, our chef prepares three to five-course dinners that are sure to delight your taste buds.

And what's a trip to the Murray without a classic Australian BBQ under the stars? Watching the sunset on the banks of the Murray is an extraordinary experience that enhances the sounds of the Murray as birds prepare to nest for the evening. All our cruises include an invitation to indulge in this Australian tradition, complete with toasting marshmallows for supper, at our riverside dining table and campfire.

We understand that some guests may have dietary requirements, and our chef can cater to most requests, so please let us know in advance.

We don't allocate meal seating while onboard Emmylou, so you are free to enjoy a meal with fellow passengers or have a quiet dinner with your partner on the deck. A wide variety of drinks, including wine, beer, aperitifs, and soft drinks, are available from the bar, and we are proud to support local wineries.

“Delicious Cuisine from breakfast, morning tea and lunch to afternoon canapes and multi-course dinners”



Dining aboard Emmylou
Tantalising multi course dinners
Bountiful continental and full breakfast options
Traditional morning and afternoon teas
Vegetarian and gluten-free menu options
Fabulous choice of local and Australian wines and beverages
Complimentary selected wine & beer with Dinner service
Free seat dining
Seasonal alfresco dining with idyllic river views
Riverside BBQ dining under the stars on all cruises with live entertainment



Welcome ABOARD

Relax and enjoy the calm water and tranquil surrounds from your private room on the river.

PS Emmylou boasts eight modern and luxurious cabins, each with its own private ensuite, comfortable bedding, and high-quality linens. The cabins are equipped with individual air-conditioning systems and windows that allow fresh country air to flow in. For a direct connection with the outdoors, each cabin also has a door that opens onto the outside deck or veranda. You can stay connected during your trip thanks to the complimentary WIFI that is available throughout the boat, including in the cabins.

Please note that while complimentary coffee and tea making facilities are available in the Saloon throughout your cruise, there are no fridges or coffee/tea making facilities in the cabins.

“ I can't remember the last time I was *this relaxed* ”



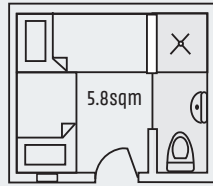

Upper Deck Twin Cabin

The Upper Deck Twin Cabin offers two full-size single beds, the top bed easily accessible, a private ensuite, and with a door that opens directly onto the deck, so you're sure to get an abundance of natural light. (6.0 sqm)

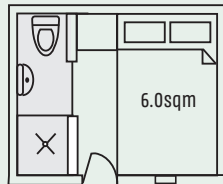

Upper Deck Double Cabin

The Upper Deck Double Cabin offers a private and comfy sanctuary. Each cabin has a snug double bed, private ensuite and a door opening directly onto the deck. (6.0 sqm)

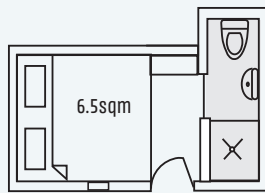

Main Deck Queen Cabin

This private cabin boasts a plush queen bed and private ensuite. The cabin is conveniently located on the main deck with close proximity to the saloon. (6.5 sqm)

Upper Deck Queen Cabin

The Upper Deck Queen Cabins allow the outside in, with large doors opening directly onto the veranda. A plush queen bed, with private ensuite makes this a perfect haven to retire to in the evenings. (6.5 sqm)

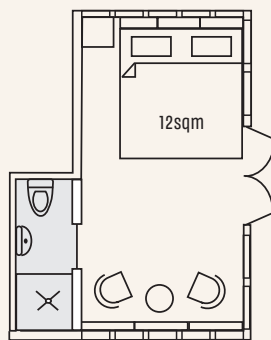

Emmylou Queen Suite

The Emmylou Queen Suite is the boat's premier suite and the most spacious. Located on the upper deck, this elegant suite features plush queen bedding, an ensuite and a seating area. French doors open directly onto the veranda, where you can relax with a drink in hand and take in the ambience as you cruise the Murray River. (12 sqm)

MAIN DECK

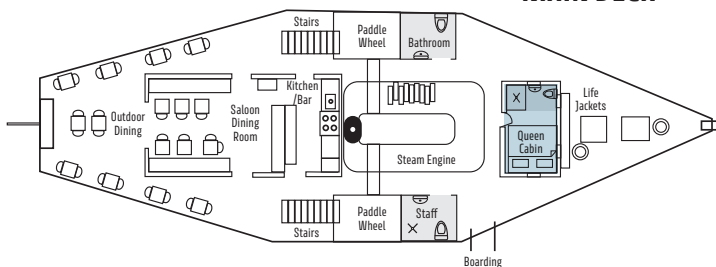

UPPER DECK

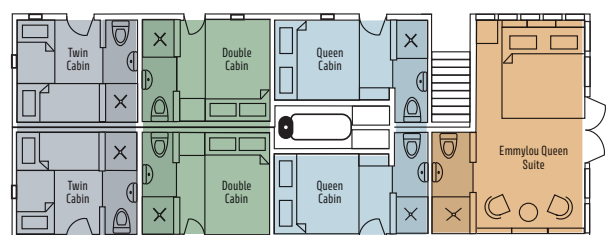



3 Night Discovery Cruise

Optional Rail

Start your river cruise from Melbourne – Complimentary. Return V/Line Train fares are included in your cruise fare.

Optional Echuca Car Parking.

Secure undercover car parking is \$30 per night.

Check In Location

Echuca Car Park – 3.00pm.

Departure & Arrival Times

Cruises depart every Friday, 4.00pm from Echuca.

Disembarking Monday, 9.30am at Torrumbarry.

Highlights

Join us for an unforgettable onshore tour that includes a visit to the Great Aussie Beer Shed & Heritage Farm Museum.

Embark on an expedition eco-cruise aboard the Murray Explorer and enjoy a scenic lunch on the riverbanks.

Indulge in tastings of the table and fortified wines at Morrisons Riverside Winery.

Explore Perricoota Station's gardens and marvel at the beauty of the filming location for the famous Australian television series, All the Rivers Run.

End your day with a memorable riverside BBQ dining experience under the stars, with live entertainment and a crackling campfire.

Take in the beauty of the Torrumbarry Weir and its surroundings.

Experience all-day cruising with a historical commentary that will transport you back in time and immerse you in the rich cultural heritage of the Murray River region.

Inclusions

Complimentary return V/Line train fare from Melbourne

Complimentary Echuca coach transfers to/from Emmylou

Luxury air-conditioned cabin with private ensuite

All onboard meals including morning and afternoon tea

Regionally-inspired meals prepared by onboard chef

Onshore Tours

Complimentary selected wine & beer with dinner service

Espresso coffee, tea, soft drink & bottled water

Complimentary WIFI throughout the boat



Day 1. Layfield Lane

As Emmylou departs from Echuca, you can relax and enjoy an afternoon Devonshire tea while taking in the stunning sights and sounds of the river. You will have plenty of time to chat with the skipper and learn about the history of the vessel or simply unwind in your private cabin.

As the sun begins to set, Happy Hour starts, where you can enjoy a drink in the saloon before arriving at Layfield Lane for a grand dinner on the riverbank. The signature Australian BBQ, lit by candles and stars, sets the perfect mood for an evening of casual conversation and live entertainment around the campfire.

Day 2. Deep Creek Marina

After a satisfying breakfast, you will embark on a half-day land and river tour, visiting the Great Aussie Beer Shed & Heritage Farm Museum. This unique attraction is a celebration of Australia's love of beer and features an extensive collection of over 17,000 cans and bottles from around the world.

You'll then experience the magic of the Murray River on our Eco Expedition boat, the Murray Explorer. After enjoying morning tea at the historic Echuca Wharf, you'll embark on a journey upriver, immersing yourself in the natural wonders of the Murray River.

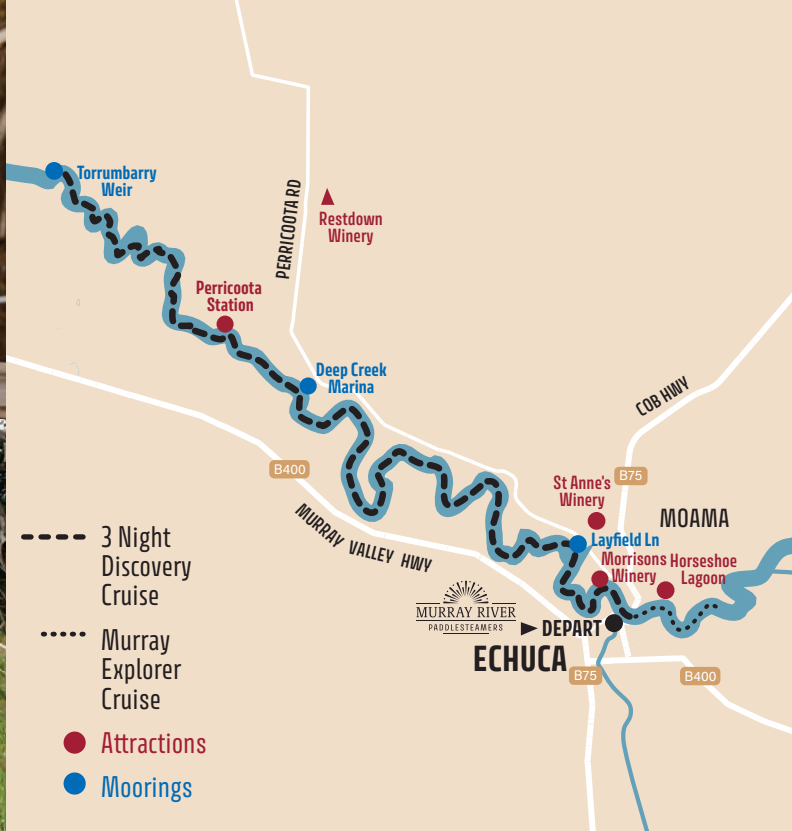

As you cruise, you'll witness breathtaking scenery and diverse wildlife, all while learning about the rich history of the river from pre-European to early colonial riverboat days. Afterward, we'll make a stop at a remote sandy river beach where you'll enjoy a delicious lunch, surrounded by the beauty of this iconic Australian destination.

Later, you will visit Morrisons Riverside Winery for a quick tasting of their fabulous table and fortified wines before returning to Emmylou for an afternoon tea service as you continue downriver towards Deep Creek Marina. In the evening, you can unwind with a fascinating documentary featuring archival footage of the paddlesteamers and communities of the Murray River.

Day 3. Torrumbarry Weir

Today Emmylou departs early in the morning for a full day of cruising towards Torrumbarry Weir with a mid-morning stop at the famous Perricoota Station. Join the skipper for a walking tour of the historic buildings and immaculate gardens of Perricoota Station before continuing towards Torrumbarry Weir.

Upon arrival, you can take a guided walk across the weir, visit the Interpretive Centre and learn about the Murray Darling Basin and the weir and lock system that dates back to 1923.

Tonight, enjoy a delicious final dinner hosted by your Skipper with pre-dinner canapes and drinks as the sun settles over the weir. Listen to the river birds' evening chorus and watch for kangaroos, wombats, and various bird species as the stars begin to appear during dinner.

Day 4. Echuca

This morning, early risers can enjoy a riverside stroll before breakfast. A courtesy vehicle will then be ready to return you to Echuca, where you will reluctantly say farewell to your unforgettable river journey on the PS Emmylou.



FROM \$1,470 PER PERSON TWIN SHARE

Month	Best Price From*	Twin Cabin	Double Cabin	Queen	Emmylou Suite
April	\$1,650	\$1,800	\$1,800	\$1,830	\$2,160
May	\$1,650	\$1,800	\$1,800	\$1,830	\$2,160
June	\$1,470	\$1,620	\$1,620	\$1,647	\$2,160
July	\$1,470	\$1,620	\$1,620	\$1,647	\$2,160
Aug	\$1,470	\$1,620	\$1,620	\$1,647	\$2,160
Sept	\$1,650	\$1,800	\$1,800	\$1,830	\$2,160
Oct	\$1,650	\$1,800	\$1,800	\$1,830	\$2,160
Nov	\$1,650	\$1,800	\$1,800	\$1,830	\$2,160
Dec	\$1,650	\$1,800	\$1,800	\$1,830	\$2,160
Jan	\$1,650	\$1,800	\$1,800	\$1,830	\$2,160
Feb	\$1,650	\$1,800	\$1,800	\$1,830	\$2,160
Mar	\$1,650	\$1,800	\$1,800	\$1,830	\$2,160

BOOK with Friends

* Save up to \$666 per couple.

when cruising off peak and booking and cruising together with eight or more guests.

Coach Transfers: Your fare includes complimentary coach transfers from our Echuca Car Park/Train Station to Emmylou at the beginning and end of your cruise.

3 Night DISCOVERY CRUISE



4 Night Explorer Cruise

Optional Rail

Start your river cruise from Melbourne – Complimentary. Return V/Line Train fares are included in your cruise fare.

Optional Echuca Car Parking.

Secure undercover car parking is \$30 per night.

Check In Location

Echuca Car Park – 3.00pm.

Departure & Arrival Times

Cruises depart every Monday, 4.00pm from Torrumbarry.

Disembarking Friday, 9.30am at Echuca.

Highlights

Enjoy an owner-led guided tour of Restdown Winery & wetlands, followed by a delicious lunch.

Take a town tour of historical Echuca sites and learn about the rich local history.

Embark on an expedition eco-cruise aboard the Murray Explorer and enjoy a scenic lunch on the riverbanks.

Indulge in tastings of table and fortified wines at St Anne's Winery.

Explore the beautiful gardens of Perricoota Station, the famous filming location for All the Rivers Run.

End your day with a memorable riverside BBQ dining experience under the stars, complete with live entertainment and a crackling campfire.

Take in the stunning beauty of the Torrumbarry Weir and its surroundings.

Experience all-day cruising with a historical commentary that will transport you back in time and immerse you in the rich cultural heritage of the Murray River region.

Inclusions

Complimentary return V/Line train fare from Melbourne

Complimentary coach transfers to/from Emmylou

Luxury air-conditioned cabin with private ensuite

All onboard meals including morning & afternoon tea

Onshore tours

Regionally-inspired meals prepared by onboard chef

Complimentary selected wine & beer with dinner service

Espresso coffee, tea, soft drink & bottled water

Complimentary WIFI throughout the boat

Day 1. Norris Bend

As Emmylou departs Torrumbarry upstream, take the opportunity to savour an afternoon Devonshire tea while enjoying the picturesque views and acquainting yourself with fellow cruisers.

You may chat with the skipper in the wheelhouse to learn about PS Emmylou's river history, relax in your private cabin or relish a drink in the saloon during "Happy Hour" as the sun sets.

In the evening, the crew will have a riverside campfire ready for you to enjoy after a chef-prepared welcome dinner at Norris Bend. Keep an eye out for kangaroos, wombats, and birds as you bask in the river birds' evening chorus and the emerging stars.

Day 2. Perricoota Station

After a hearty breakfast, PS Emmylou will cruise to the famous Perricoota Station. You'll have the opportunity to board of coach to visit Restdown Winery joining the property's owners for a guided tour along a 1.4km wetlands walking trail, highlighting items of Aboriginal significance before enjoying a gourmet lunch of local produce and wine tastings.

Afterward, you'll walk along the historic buildings and immaculate gardens of Perricoota Station before enjoying a fabulous dinner on Emmylou's deck overlooking the famous property and river.

The night will conclude with a fascinating documentary featuring archival footage of the paddlesteamers and communities of the Murray River.

Day 3. Layfield Lane

For early risers and avid photographers, the morning mist and wildlife around Perricoota is a spectacle to behold. Enjoy a full day of cruising upstream towards Layfield Lane with lunch on the deck or in the saloon.



Afterward, experience a grand dinner on the riverbank with our signature Australian BBQ, followed by live entertainment and casual conversation around the campfire (weather dependent).

Day 4. Moama Wharf

Begin your day with a rewarding breakfast before embarking on a half-day land and river tour. Your tour explores the historic town of Echuca discovering little-known historic sites such as Hopwood's Punt and pontoon bridge, which was the first crossing of the river created by Echuca's founder Henry Hopwood.

You'll then experience the magic of the Murray River on our Eco Expedition boat, the Murray Explorer. After enjoying morning tea at the historic Echuca Wharf, you'll embark on a journey upriver, immersing yourself in the natural wonders of the Murray River.

As you cruise, you'll witness breathtaking scenery and diverse wildlife, all while learning about the rich history of the river from pre-European to early colonial riverboat days. Afterward, we'll make a stop at a remote sandy river beach where you'll enjoy a delicious lunch, surrounded by the beauty of this iconic Australian destination.

We then visit St Anne's winery, Perricoota region's largest winery for a quick tasting of their fabulous table and fortified wines before returning to Emmylou for an afternoon tea service as you continue upriver towards mooring overnight at Moama Wharf.

Day 5. Echuca

Before breakfast, early risers can enjoy a wander along the boardwalks of Horseshoe Lagoon, indulging in some wildlife spotting and learning about the importance of wetlands and floodplains along the mighty Murray River before PS Emmylou departs for the Port of Echuca, where we reluctantly say farewell.



FROM \$2,010 PER PERSON TWIN SHARE

Month	Best Price From*	Twin Cabin	Double Cabin	Queen	Emmylou Suite
April	\$2,250	\$2,400	\$2,400	\$2,440	\$2,880
May	\$2,250	\$2,400	\$2,400	\$2,440	\$2,880
June	\$2,010	\$2,160	\$2,160	\$2,196	\$2,880
July	\$2,010	\$2,160	\$2,160	\$2,196	\$2,880
Aug	\$2,010	\$2,160	\$2,160	\$2,196	\$2,880
Sept	\$2,250	\$2,400	\$2,400	\$2,440	\$2,880
Oct	\$2,250	\$2,400	\$2,400	\$2,440	\$2,880
Nov	\$2,250	\$2,400	\$2,400	\$2,440	\$2,880
Dec	\$2,250	\$2,400	\$2,400	\$2,440	\$2,880
Jan	\$2,250	\$2,400	\$2,400	\$2,440	\$2,880
Feb	\$2,250	\$2,400	\$2,400	\$2,440	\$2,880
Mar	\$2,250	\$2,400	\$2,400	\$2,440	\$2,880

BOOK with Friends

* Save up to **\$788** per couple

when cruising off peak and booking and cruising together with eight or more guests.

Coach Transfers: Your fare includes complimentary coach transfers from our Echuca Car Park/Train Station to Emmylou at the beginning and end of your cruise.

4 Night EXPLORER CRUISE



7 Night All the Rivers Run Cruise

Optional Rail

Start your river cruise from Melbourne – Complimentary. Return V/Line Train fares are included in your cruise fare.

Optional Echuca Car Parking.

Secure undercover car parking is \$30 per night.

Check In Location

Echuca Car Park – 3.00pm

Departure & Arrival Times

Cruises depart every Monday, 4.00pm from Torrumbarry.

Disembarking Following Monday, 9.30am at Torrumbarry

Highlights

Enjoy multiple unique sightseeing tours throughout the Murray River region.

Join an owner-led guided tour of Restdown Winery & wetlands, followed by a delicious lunch.

Learn about the rich local history on a town tour of historical Echuca sites.

Visit the Great Aussie Beer Shed & Heritage Farm Museum on an unforgettable onshore tour.

Enjoy a regional Silo Arts Tour and have lunch at the Colbinabbin Pub, followed by an Echuca Walking Tour.

Embark on an expedition eco-cruise aboard the Murray Explorer and enjoy a scenic lunch on the riverbanks.

Indulge in tastings of table and fortified wines at two regional wineries.

Explore the beautiful gardens of Perricoota Station, a famous filming location for All the Rivers Run.

End your day with a memorable riverside BBQ dining experience under the stars, complete with live entertainment and a crackling campfire.

Take in the stunning beauty of the Torrumbarry Weir and its surroundings.

Experience all-day cruising with a historical commentary that will transport you back in time and immerse you in the rich cultural heritage of the Murray River region.

Inclusions

Complimentary return V/Line train fare from Melbourne

Complimentary transfer to/from Emmylou

Luxury air-conditioned cabin with private ensuite

All onboard meals including morning & afternoon tea

Four Onshore tours

Regionally-inspired meals prepared by onboard chef

Complimentary selected wine & beer with dinner service

Espresso coffee, tea, soft drink & bottled water

Complimentary WIFI throughout the boat

Day 1. Norris Bend

As Emmylou departs Torrumbarry and have the opportunity to indulge in an afternoon Devonshire tea while taking in the scenic views and getting to know your fellow cruisers. You can chat with the skipper in the wheelhouse and learn about the river history of PS Emmylou or unwind in your private cabin or the saloon during "Happy Hour" as the sun sets.

In the evening, the crew will set up a riverside campfire for you to enjoy after a welcome dinner at Norris Bend, prepared by the chef. You can also look out for kangaroos, wombats, and birds while taking in the evening chorus of the river birds and the emerging stars.

Day 2. Perricoota Station

After a hearty breakfast before cruising to the famous Perricoota Station. You'll have the chance to board our coach for a visit to Restdown winery with the property's owners, walk along a 1.4km wetlands trail with significant Aboriginal items, and enjoy a gourmet lunch of local produce and wine tastings.

You can then explore the historical buildings and immaculate gardens of Perricoota Station before having dinner on Emmylou's deck overlooking the mansion.

The night will conclude with a fascinating documentary featuring archival footage of the paddlesteamers and communities of the Murray River.

Day 3. Layfield Lane

For early risers and avid photographers, the morning mist and wildlife around Perricoota is a spectacle to behold. You'll then spend the whole day cruising upstream towards Layfield Lane, enjoying lunch on the deck or in the saloon.

In the evening, you can experience a grand dinner on the riverbank with the signature Australian BBQ, followed by live entertainment and casual conversation around the campfire (weather dependent).

Day 4. Moama Wharf

Begin your day with a satisfying breakfast before embarking on a half-day land and river tour. Your tour explores the historical town of Echuca discovering little-known historical sites such as Hopwood's Punt and pontoon bridge, which was the first crossing of the river created by Echuca's founder Henry Hopwood.

You'll then experience the magic of the Murray River on our Eco Expedition boat, the Murray Explorer. After enjoying morning tea at the historic Echuca Wharf, you'll embark on a journey upriver, immersing yourself in the natural wonders of the Murray River.

As you cruise, you'll witness breathtaking scenery and diverse wildlife, all while learning about the rich history of the river from pre-European to early colonial riverboat days. Afterward, we'll make a stop at a remote sandy river beach where you'll enjoy a delicious lunch, surrounded by the beauty of this iconic Australian destination.

We then visit St Anne's winery, Perricoota region's largest winery for a quick tasting of their fabulous table and fortified wines before returning to Emmylou for an afternoon tea service as you continue upriver towards mooring overnight at Moama Wharf.

Day 5. Echuca & Layfield Lane

This morning Emmylou cruises into the Port of Echuca, which was first built in the 1860s to support the booming river trade and was once the largest inland port in Australia.

You'll enjoy a half-day tour visiting two spectacular local art silos at Rochester and Colbinabbin, stopping for lunch at the local pub before visiting the fabulous Kyabram water tank. Returning to Echuca, explore the historical port precinct on a guided walking tour and visit the High Street shops and cafes.

Back aboard Emmylou, you can enjoy an afternoon Devonshire tea while cruising downstream. Happy Hour starts as the sun sets, where you can enjoy a drink in the saloon before arriving at Layfield Lane for a grand dinner on the riverbank with the signature Australian BBQ.

Day 6. Deep Creek Marina

After a rewarding breakfast, you will embark on a half-day land and river tour that includes a visit to the Great Aussie Beer Shed & Heritage Farm Museum. This unique attraction celebrates Australia's love for beer and boasts a vast collection of over 17,000 cans and bottles from all over the world.

Its then time for an unforgettable Eco Expedition on the Murray Explorer, where you'll discover the enchanting beauty of the Murray River. We begin with a delightful morning tea at the historic Echuca Wharf before setting off upriver.

As you cruise, you'll witness breathtaking scenery and diverse wildlife, all while learning about the rich history of the river from pre-European to early colonial riverboat days. After a thrilling journey, we'll make a stop at a remote sandy river beach where you'll savor a delicious lunch amidst the stunning natural surroundings of this iconic Australian destination.

On your return to Emmylou we visit Morrisons riverside winery for a quick tasting of their fabulous table and fortified wines before returning to Emmylou for an afternoon tea service as you continue downriver towards Deep Creek Marina.



Day 7. Torrumbarry Weir

PS Emmylou departs early for a full day of cruising with a stop at the famous Perricoota Station before continuing downriver towards Torrumbarry Weir. Upon arrival, you can take a guided walk across the weir with the Skipper, visiting the Interpretive Centre and learning about the Murray Darling Basin, the weir, and the lock system that dates back to 1923. Tonight, enjoy a delicious final dinner hosted by your Skipper with pre-dinner canapes and drinks as the sun settles over the weir. Listen to the river birds' evening chorus and watch for kangaroos, wombats, and various bird species as the stars begin to appear during dinner.

Day 8. Echuca

Early risers can enjoy a riverside stroll before breakfast. A courtesy vehicle will then be ready to return you to Echuca, where you will reluctantly say farewell to your unforgettable river journey on the PS Emmylou.

FROM \$3,630 PER PERSON TWIN SHARE

Month	Best Price From*	Twin Cabin	Double Cabin	Queen	Emmylou Suite
April	\$4,050	\$4,200	\$4,200	\$4,270	\$5,040
May	\$4,050	\$4,200	\$4,200	\$4,270	\$5,040
June	\$3,630	\$3,780	\$3,780	\$3,843	\$5,040
July	\$3,630	\$3,780	\$3,780	\$3,843	\$5,040
Aug	\$3,630	\$3,780	\$3,780	\$3,843	\$5,040
Sept	\$4,050	\$4,200	\$4,200	\$4,270	\$5,040
Oct	\$4,050	\$4,200	\$4,200	\$4,270	\$5,040
Nov	\$4,050	\$4,200	\$4,200	\$4,270	\$5,040
Dec	\$4,050	\$4,200	\$4,200	\$4,270	\$5,040
Jan	\$4,050	\$4,200	\$4,200	\$4,270	\$5,040
Feb	\$4,050	\$4,200	\$4,200	\$4,270	\$5,040
Mar	\$4,050	\$4,200	\$4,200	\$4,270	\$5,040

BOOK with Friends

* Save up to **\$1,154** per couple

when cruising off peak and booking and cruising together with eight or more guests.

Coach Transfers: Your fare includes complimentary coach transfers from our Echuca Car Park/Train Station to Emmylou at the beginning and end of your cruise.

Extend YOUR STAY



Hotels

Echuca Moama is a destination in its own right and truly worth exploring. Staying a day or two before boarding your cruise, or after you return to dock, is a great way to immerse yourself in regional Australia. We're delighted to partner with an award-winning hotel in Echuca conveniently located close to the port and several Melbourne hotels for those travelling further afield. Pre and post-cruise accommodation can be booked directly through Murray River Paddle Steamers.

Echuca Undercover Car Parking

Secure undercover warehouse parking is available for cruise passengers' cars and small caravans at a rate of \$30 per day. Prior reservation is required. Please contact us if you have a larger vehicle/caravan.



Mercure Port of Echuca Hotel

Superior King Room \$200 per night

Extend your experience in Echuca with a pre or post-cruise stay at the Mercure Port of Echuca Hotel. Located in the centre of town, within walking distance to the port and High Street shops, our exclusive rate offers you a Deluxe Room featuring a king bed, plasma TV and DVD player, exquisite bathroom, pay-TV and wireless internet access.



48 Hours in Echuca Moama

Arriving at the twin towns of Echuca Moama nestled on Australia's longest navigable river, replete with Mediterranean climate, you'll be able to boast about visiting two Australian states (NSW & Victoria) in one day. 48 hours in Echuca Moama provides a suggested highlights itinerary to make the most of your stay.

Day 1

9am Breakfast

Indulge in one of the many coffee spots around town – enjoy breakfast at one of the quaint sidewalk cafes

10am Mid Morning

Step into the historic Port precinct, wander through the heritage streetscape, taking in the artists at work, the galleries, the winery, fudge shop, blacksmith at work & hop aboard the horse and carriage for a short ride around the town. Browse the displays telling stories of the river trade at the Port of Echuca Discovery Centre & the historic wharf.

11am Wharf To Winery

Indulge in Australia's most unique restaurant aboard one of the Australia's historic Paddlesteamers, while cruising the river. Take the Wharf to Winery cruise, enjoying lunch at Morrisons Winery overlooking the vineyards & river.

2.30pm Early Afternoon

Having spent a leisurely few hours dining on or near the river, ramp it up with a visit to the strawberry farm (October – May) to pick your own strawberries and have a mid afternoon strawberry ice cream – breathe in the strawberry aroma while the luscious red berries are succulently warm and ready for tasting.

4pm Late Afternoon

Call into the great Aussie Beer Shed on the way home to Echuca and marvel at the Australiana collection and unlock the stories of many facets of Australian life. Back in town refresh at your accommodation and take a walk along the banks of the river through the stands of river red gums. Enjoy dusk with the setting sun as the birds fly in and sing their evening songs.

8pm Dinner

Dine at one of Echuca Moama's signature restaurants – the choice is yours! Local produce from the nearby farms and fruit and vegetable gardens are showcased on the menus. Tasting the local wines or craft beers you'll be spoilt for choice.

Day 2

7am Early Morning

For those that like some early morning activity – jump on a stand-up paddleboard (SUP) and literally walk on water! Savour the stillness of the morning, with the light streaming through the river red gums with a pale pink sky and the fresh clear morning air – you'll never want to leave! For those who would prefer an early morning walk or jog, the river setting provides for a great meditative experience - one you won't forget.

9 am Breakfast

To cool off, sit in one of the outdoor cafes or indulge in one of the many quaint little cafes around town! A smoothie, a caffeine heart starter or tingling fresh water is a great way to refresh after the early morning activity.

10am Mid Morning

Wander the Historic Port Precinct and High Street Shops. Visit the Echuca Historical Society for a history lesson of the river and local communities.

12 Noon Lunch

Feed your appetite with a lunch at one of our many eating spots – Mediterranean, Vegan, Pub or Asian are all there for you to try.

2pm Early Afternoon

A short drive to the township of Kyabram 30 minutes away you'll find a quaint little Australian town where there is still a glimmer of yesteryear. Shop, visit the Kyabram Town Hall with its quality art and fashion exhibitions, don't miss the Kyabram Fauna Park with its up close and personal Australian animal experiences and drop into the camel farm for an interesting encounter with the camels.

4pm Late Afternoon

To complete the day pop into the, flour mill or local pub – they all provide an insight into the unique way of Australian life.

7pm Evening

In winter book dinner at one of the many local pubs with a roaring fire. In summer become part of the local scene and enjoy some of the balmy evenings in the beer gardens, clubs, pubs or music venues.

Extend YOUR STAY



Driving TOUR ROUTES TO ECHUCA

Adelaide to Echuca – Follow the Murray Route

Highlights

Sip wine at quaint cellar doors in Victoria & South Australia

Explore the largest open range Zoo in the world

Cross in NSW from Mildura and explore NSW Perry Sandhills

Step back in time with a visit to the Swan Hill Pioneer Settlement

Day 1 - Head from Adelaide to Murray Bridge where your Murray River drive adventure really begins. Along the way enjoy the heritage town of Hahndorf in the Adelaide Hills known for its cool-climate wines and Australia's oldest surviving German settlement. Stop by the Murray Bridge Regional Gallery where you'll find contemporary craft and artworks.

Day 2 - This morning visit the fabulous Monarto Safari Park, the largest open-range Zoo in the world. It is then time to check out Caudo Vineyard before heading to Renmark where you can relax and enjoy some outstanding food and wine from Banrock Station Wine and Wetland Centre.

Day 3 - It is time to cross the border driving 1.5 hours to Mildura in Victoria, a town of rugged nature and quiet charm. Cross the

border into NSW to visit the Perry Sandhills perfect for a picnic and then finish the day at Red Cliffs Lookout where you will find auburn cliffs carved by the Murray River.

Day 4 - Say goodbye to Mildura and set your sights on Swan Hill. It's about a 2.5 hour drive, but be sure to take your time as you weave alongside rivers and lakes. After you arrive in Swan Hill, explore the nearby Pioneer Settlement. Set on the banks of the Little Murray River, the Settlement tells the history of the Murray River with horse-drawn vehicles, blacksmiths, print shops.

Day 5 - A short drive to Echuca where you can board PS Emmylou and experience the Port of Echuca precinct. In the 1870s, this was the third-largest port in Australia, behind only Sydney and Melbourne.



Driving TOUR ROUTES TO ECHUCA

Adelaide to Echuca – Inland Gourmet Trail

Highlights

Visit world heritage Naracoote Caves and experience the underground world

Savour the delights of the premier Coonawarra wine district

Explore the Southern Grampians and dine at the renowned Royal Mail Hotel

Delve into Australia Gold Rush history visiting Sovereign Hill, Ballarat

Uncover Bendigo's fabulous Art and Food culture

Day 1 - This morning rise early for the drive to Naracoote in the limestone region of South Australia. Visit the Australian Fossil Mammal site, then visit the natural wonders of the Naracoote Caves National Park with guided tours in the Alexandra and Victoria caves.

Day 2 - Today visit the Coonawarra wine region, world-renowned for its Cabernet Sauvignon. See why it's called the Bordeaux of Australia, with 30 winery cellar doors. Visit historic Wynns Coonawarra Estate featuring the famous triple-gable roof and stone buildings, and Rymill Coonawarra with its full-sized bronze dancing horses, art and viewing gallery.

Day 3 - Today we cross the border into Victoria visiting the beautiful city of Hamilton and the Hamilton Galley, before arriving in the Southern Grampians at Dunkeld. Visit the famous Royal Mail Hotel where the mountains provide a

stunning backdrop for a fine dining experience and overnight stay.

Day 4 - Set your sights on Gold Country with a visit to Ballarat and Sovereign Hill, a recreated gold rush town and outdoor museum. Explore tunnels, shops, streetscapes and pan for real gold. If staying longer book an overnight stay at Craig's Royal Hotel. It's then time to visit Bendigo, the original gold rush boom town and home to the Centre Deborah Gold Mine. Explore its vibrant arts hub and world-class food and wine scene, set against rich gold-rush history, grand architecture and magnificent gardens.

Day 5 - A short drive to Echuca where you can board PS Emmylou and experience the Port of Echuca precinct. In the 1870s, this was the third-largest port in Australia, behind only Sydney and Melbourne.



Driving TOUR ROUTES TO ECHUCA

Sydney to Melbourne Coast & Country Explorer Route – Via Echuca

Highlights

Join a local Aboriginal guide for an insightful look into the lives of the local Yuin people.

See kangaroos playing in the waves at Pebbly Beach.

Explore incredible exhibits at MAMA – Murray Arts Museum Albury.

Indulge the taste buds on a food fossicking tour in Bendigo.

Day 1 – Exchange urban views for the natural wonders of the coast as you begin the drive south to Melbourne via Echuca. The route takes you over the Sea Cliff Bridge which curves around the cliffs, floating 665 metres above the ocean waves. Arriving at Jervis Bay. Here, you'll find glorious white sandy beaches plus a mischievous pod of resident dolphins that play in the bay all year round.

Day 2 – Take your time as you head onwards today. Ulladulla is only a short drive from Jervis Bay but packed with art galleries and treasured curio shops. Seafood lovers should check out the Oyster Shed on Wray Street as you pass through Bateman's Bay. Meandering ever southwards Bermagui is a pretty, coastal village famed for the crystalline blue waters that surround it and the famous Blue Rock Pool. From this charming spot continue to Merimbula.

Day 3 – Today is a real road-trip. The route takes you deep into the legendary Snowy Mountains passing Lake Jindabyne and Mt Kosciuszko as you follow the Kosciuszko Alpine Way. Your destination is the twin cities of Albury Wodonga, straddling the Murray River.

Day 4 – Today you're heading for Echuca Moama. Named after the Aboriginal word for 'meeting of the waters,' Echuca was once one of the busiest ports on the Murray River. Now, the twin towns of Echuca Moama are steeped in history. As you stroll along Murray Esplanade, where heritage buildings now house vibrant shops and cafes, the atmosphere of a bygone age is almost tangible. Time to board your PS Emmylou overnight cruise before ending your tour in Melbourne via Bendigo.



Driving TOUR ROUTES TO ECHUCA

Albury to Echuca – Murray River Route

Highlights

Explore Murray Arts Museum Albury.

Visit Corowa's Federation Museum & Whisky Factory.

Relax on Lake Mulwala or discover riverside walking tracks.

Indulge in the many gourmet food produced at Rich Glen Olive Estate.

Day 1 – Head for Corowa following the Riverina Highway west through countryside patchworked with emerald farmland. Arrive in Corowa and discover a town that played a big role in federation, leading the charge to unite Australia's six colonies. The fascinating story is detailed at the Corowa Federation Museum, which also houses a collection of historic Aboriginal artefacts. Sample more of the region at Corowa Whisky and Chocolate, occupying 1920s flour mills now a on-site distillery producing a fiery single malt, plus port, sherry and bourbon, alongside handmade chocolate blocks and bars.

Day 2 – Head to Yarrawonga-Mulwala. These twin cities occupying each bank of the Murray

wraps up by skirting man-made Lake Mulwala. This redgum-ringed reservoir boasts enormous populations of cod and crayfish. Explore walking trails, rent a kayak and soak up the serenity while bird-watching.

Day 3 – The journey from Mulwala to Tocumwal hugs the river, passing the Big Reedy Lagoon Wildlife Reserve (a twitcher's paradise) along the way. Visit the historic Aerodrome Museum, which tells the story of Tocumwal's significance during WWII. The day's final 110km journey to Echuca is where you can board PS Emmylou for your overnight cruise departing from the Port of Echuca, once the third-largest port in Australia, behind only Sydney and Melbourne.



MURRAY RIVER
PADDLESTEAMERS
ECHUCA



*"I fell in love with her
and everyone who sails on her
feels the same."*

REQUEST MORE INFORMATION
57 Murray Esp, Echuca, VIC 3564
CALL 03 5482 5244
EMAIL info@mrps.com.au
VISIT psemmyloucruises.com

For reservations contact your travel agent: